

PT-G503-PHR-PTP Series

IEC 61850-3/62439-3 3-port full Gigabit managed redundancy boxes



- > IEC 61850-3, IEEE 1613 (power substations) compliant
- > IEC 62439-3 Clause 4 (PRP) and Clause 5 (HSR) compliant
- > PRP/HSR Coupling and QuadBox functions supported
- > Ethernet console reserved for local access
- > Built-in MMS server, based on IEC 61850-90-4 switch modeling for power SCADA
- > Hardware-based IEEE 1588v2 PTP supported
- > Design ready for NERC CIP compliant system development
- > Isolated redundant power inputs with universal 24/48 VDC or 110/220 VDC/VAC power supply range
- > -40 to 85°C operating temperature range



Introduction

The PT-G503-PHR-PTP series redundancy boxes (RedBoxes) are compliant with the latest standardized redundancy protocols for industrial automation networks, IEC 62439-3 Clause 4 (Parallel Redundancy Protocol, PRP) and IEC 62439-3 Clause 5 (High-availability Seamless Redundancy, HSR). PRP/HSR ensures the highest system availability and data integrity for mission-critical applications in electrical substation and/or process automation systems that require zero recovery time redundancy. The redundant protocols Coupling and QuadBox are also supported. With Coupling and QuadBox, HSR rings can be connected to make the redundant network more versatile. The PT-G503-PHR-PTP series comes with three 10/100/1000BaseT(X) and 100/1000BaseSFP slot combo ports.

One slot (INTERLINK port) is for an internal link for connecting with a SAN (Singly Attached Node). The other two ports (LAN A and LAN B ports) are for PRP/HSR redundant protocol communications. With this full Gigabit Ethernet port design, the PT-G503-PHR-PTP series provides high performance for PRP/HSR systems.

The PT-G503-PHR-PTP series also provides IEEE 1588v2 PTP in end-to-end one-step transparent clock mode for timing-critical applications and isolated redundant power inputs with 24/48 VDC or 110/220 VDC/VAC power supply ranges to increase the reliability of the power supply.

General Features and Benefits

- PRP (Parallel Redundancy Protocol): Transmit or receive two independent active paths to/from different LANs simultaneously on a zero recovery time network.
- HSR (High-availability Seamless Redundancy): Every frame is duplicated and then transmitted in both directions of the HSR ring to deliver zero switchover time.
- PRP/HSR coupling: Supports coupling from an HSR ring node to redundant PRP LANs (Up to 7 PRP LANs).
- QuadBox function: Supports peer coupling of rings via interconnecting two INTERLINK ports on two separate RedBoxes.
- Fiber Check™ provides monitoring and diagnosis functionality on SFP fiber ports.
- Hardware-based IEEE 1588v2 PTP (Precision Time Protocol) end-to-end one-step transparent clock for precise time synchronization of networks.
- Built-in MMS server for integration with power SCADA systems.
- Switch data modeling based on the IEC 61850-90-4 standard.
- Automatic warning by exception through email, relay output.
- Configurable via web browser, CLI, Windows utility, and ABC-02 automatic backup configurator.

Specifications

Technology

Standards:

IEEE 802.3 for 10BaseT
 IEEE 802.3u for 100BaseT(X) and 100BaseFX
 IEEE 802.3ab for 1000BaseT(X)
 IEEE 802.3z for 1000BaseX

Software Features

Management: IPv4/IPv6, PRP/HSR, SNMPv1/v2c/v3, DHCP Client, BootP, SMTP, RARP, HTTP, Telnet, LLDP, Flow Control, Back Pressure
 Flow Control, SNMP Inform, Port Mirror, Fiber Check, Syslog, RMON

Filter: Multicast Filter Behavior

Redundancy Protocols: PRP/HSR, RSTP Transparent

Security: RADIUS, TACACS+, Trusted Access Control, Authentication Certificate (SSL Certificate, SSH Key Regenerate)

Time Management: SNTP, NTP Server/Client, IEEE 1588v2 PTP

Industrial Protocols: Modbus/TCP

MIB: IEC 62439-3 MIB

Power Substation: MMS

Interface

Gigabit Ethernet: 3 x 10/100/1000BaseT(X) ports or 100/1000BaseSFP combo ports

Console Port: Ethernet console (10/100/1000 Mbps RJ45), USB-serial console (Type B connector)

Storage Port: USB storage (Type A connector for ABC-02-USB)

Alarm Contact: 1 relay output with current carrying capacity of 1 A @ 24 VDC

Digital Inputs: 1 input with the same ground, but electrically isolated from the electronics

- +13 to +30 V for state "1"
- -30 to +3 V for state "0"
- Max. input current: 8 mA

Power Requirements

Input Voltage:

- WV: 24/48 VDC
- HV: 110/220 VDC/VAC

Operating Voltage:

- WV: 18 to 72 VDC
- HV: 88 to 300 VDC, 85 to 264 VAC

Input Current:

- Max. 0.660/0.360 A @ 24/48 VDC
- Max. 0.150/0.080 A @ 110/220 VDC
- Max. 0.260/0.170 A @ 110/220 VAC

Overload Current Protection: Present

Connection: 5-pin terminal block

Reverse Polarity Protection: Present

Physical Characteristics

Housing: Aluminum alloy

IP Rating: IP40 protection

Dimensions: 80 x 160 x 110 mm (3.15 x 6.30 x 4.33 in)

Weight: 1210 g (2.69 lb)

Installation: DIN-rail mounting

Environmental Limits

Operating Temperature: -40 to 85°C (-40 to 185°F)

Storage Temperature: -40 to 85°C (-40 to 185°F)

Ambient Relative Humidity: 5 to 95% (non-condensing)

Standards and Certifications

High Availability Automation Networks: IEC 62439-3

Safety: UL 508

EMI: FCC Part 15 Subpart B Class A, EN 55032 Class A

EMS:

IEC 61000-4-2 ESD: Contact: 8 kV; Air: 15 kV

IEC 61000-4-3 RS: 80 MHz to 1 GHz: 35 V/m

IEC 61000-4-4 EFT: Power: 4 kV; Signal: 4 kV

IEC 61000-4-5 Surge: Power: 4 kV; Signal: 4 kV

IEC 61000-4-6 CS: 10 V

IEC 61000-4-8

IEC 61000-4-11

Electrical Substation: IEC 61850-3, IEEE 1613

Rail Traffic: EN 50121-4

MTBF (mean time between failures)

Time:

PT-G503-PHR-PTP-WV:440,857 hrs

PT-G503-PHR-PTP-HV:566,844 hrs

Standard: Telcordia TR/SR

Warranty

Warranty Period: 5 years

Details: See www.moxa.com/warranty

Dimensions

Unit: mm (inch)

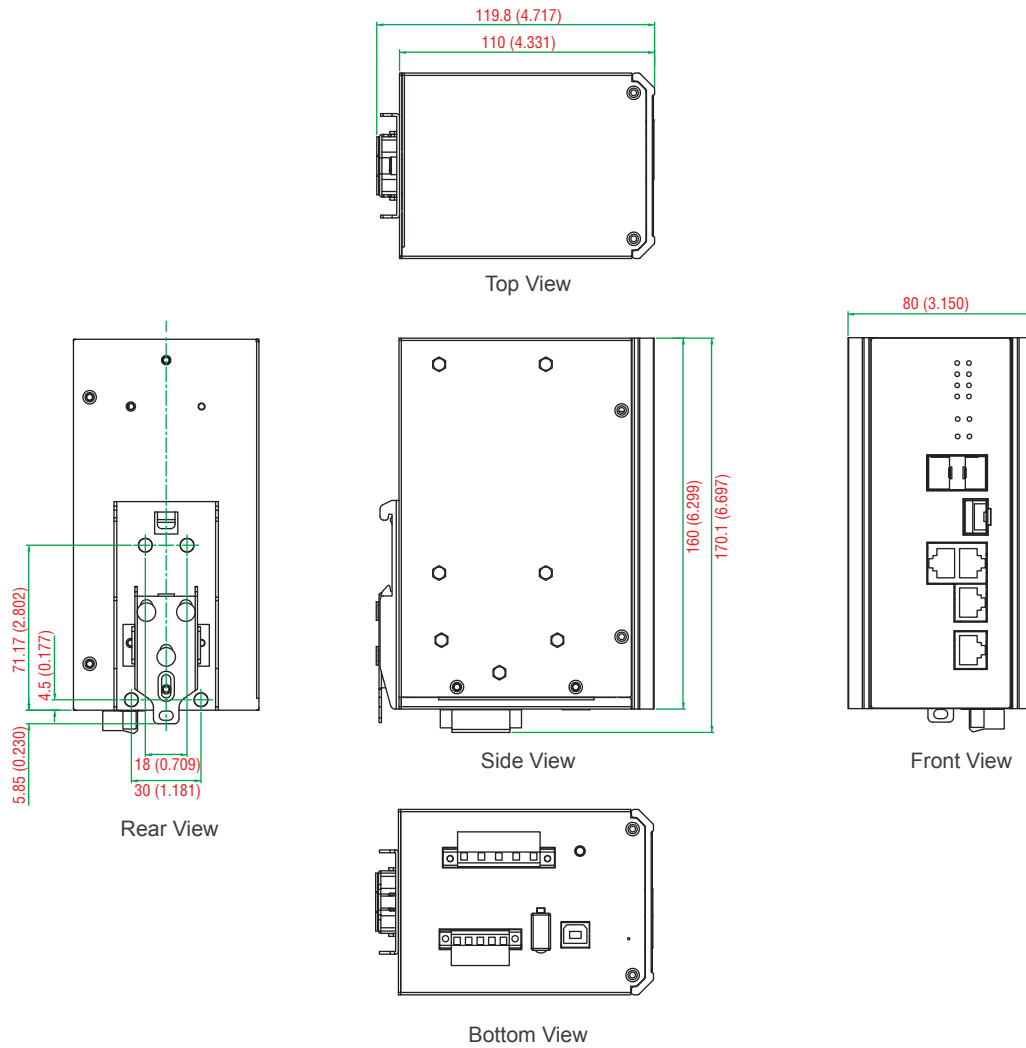

Ordering Information

Available Models		
DIN Rail, Front Cabling, Front Display	Power Supply	
	WV: 24/48 VDC (18 to 72 VDC), isolated (dual power inputs)	HV: 110/220 VDC/VAC (88 to 300 VDC, 85 to 264 VAC), isolated (dual power inputs)
PT-G503-PHR-PTP-WV	1	-
PT-G503-PHR-PTP-HV	-	1

Optional Accessories (can be purchased separately)

- EDS-SNMP OPC Server Pro:** OPC server software that works with all SNMP devices
- ABC-02 Series:** Configuration backup and restoration tool for managed Ethernet switches, 0 to 60°C operating temperature
- WK-51-01:** DIN-rail/wall-mounting kit, 2 plates with 6 screws

Package Checklist

- PT-G503-PHR-PTP redundancy box
- USB Cable: CBL-USBA/B-100
- DIN-rail kit
- Protective caps for unused ports
- Documentation and software CD
- Hardware installation guide
- Warranty card