

Power Supply Accessories

SDN-PMBRK3 Panel Mount Brackets Installation Manual



P/N: A272-289 REV. 1 (07/16)
©2016 Appleton Grp LLC d/b/a Appleton Group
All rights reserved. Specifications
subject to change without notice.



CAUTION:
Risk of Electric Shock and Personal Injury
Ensure unit is disconnected from all power sources prior to replacing brackets.

CHASSIS MOUNTING

This set consists of two panel mount brackets, which replace the existing two DIN mounting brackets at the back of the unit.

FOR USE WITH:

SDN 5-24-100C
SDN 10-24-100C
SDN 40-24-100C
SDN 10-24-480C
SDN 2X20RED

INCLUDED:

Two M3x8 mm phillips screws
Two brackets
Two lock washers

NOT INCLUDED:

Four 8-32 x 1/2" screws for mounting unit to panel
Four 8-32 flat washers

Dimensions in Inches (Millimeters)

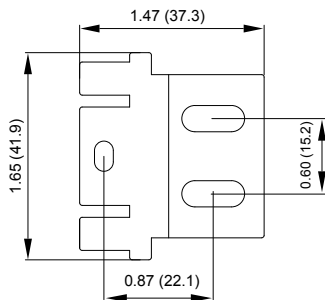

Top View

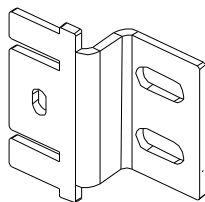

3D View

Panel Mount Brackets Installation

1. Remove the M3X6 mm Phillips Screws, shoulder screw, plastic slide, spring and C-Insert from the DIN Brackets.

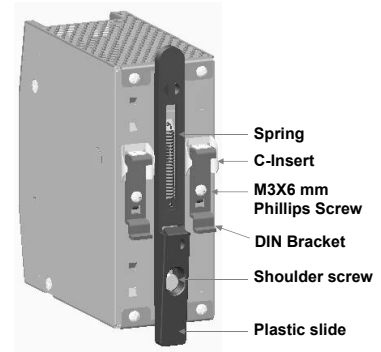

2. Retain and slide back the two DIN brackets to use as a guide for the installation of the panel mount brackets.

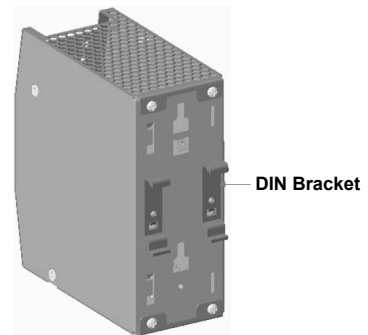

3. Push and slide the panel mount brackets on the top of DIN bracket and secure with M3X8 mm Phillips Screw and lock washer (use 7kgf torque).

