

93.68.0.024

	93.68.0.024
	U_N (12...24) V AC (50/60 Hz) / DC $U_{min} - max$ (9.6-26.4) V AC / DC
	(-20...+50)°C
	IP20

	34.81.7.xxx.xxxx (SSR)
	1NO (SPST-NO)
	9024 2 A (1.5...24)V DC 7048 0.1 A (1.5...48)V DC 8240 2 A (12...240)V AC

	34.51.7.xxx.0010 (EMR)
	1 CO (SPDT) 6 A 250 V AC
	AC1 1500 VA AC15 (230 V AC) 300 VA (230 V AC) 0.185 kW DC1 (30/110/220)V (6/0.2/0.12) A

LED	U_N	15-18 (EMR) 15-18 (SSR)
	-	
	✓	
	✓	
	✓	

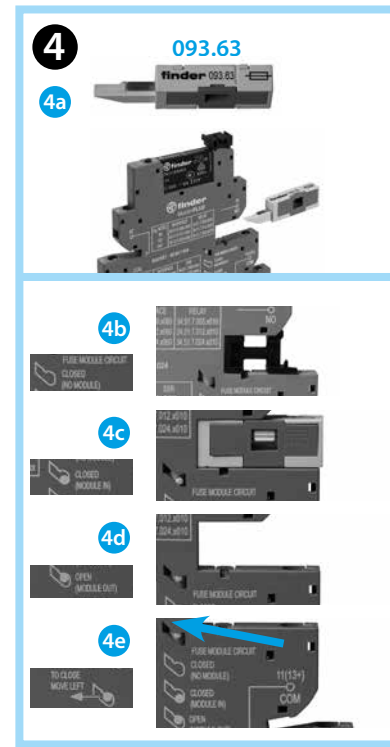
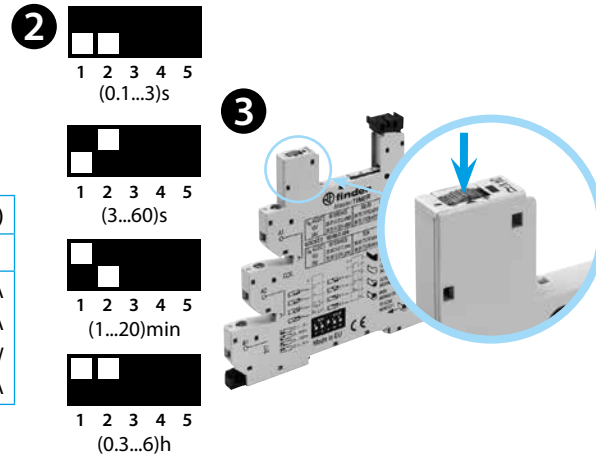

ENGLISH

93.68 TIMED SOCKET FOR 34 SERIES

- + relay 34.81: Timed interface module SSR (type 39.80)
- + relay 34.51: Timed interface module EMR (type 39.81)

1 WIRING DIAGRAMS AND FUNCTIONS

- U** Supply voltage
- S** Signal switch
- Output Contact

(without control signal)

- A1** On-delay
- D1** Interval
- G1** Pulse (0.5 s) delayed
- SW** Symmetrical flasher (starting pulse on)

(with control signal)

- BE** Off-delay with control signal
- CE** On- and off-delay with control signal
- DE** Interval with control signal on
- EE** Interval with control signal off

1a Possible to control an external load, such as another relay coil or timer, connected to the control signal terminal B1

1b A voltage other than the supply voltage can be applied to the command Start (B1), example:

- A1-A2 = 24 V AC
- B1-A2 = 12 V DC

With DC supply, positive polarity has to be connected to B1 terminal (according to EN 60204-1)

2 TIME SCALES

3 ADJUSTING THE DELAY / LED

4 ACCESSORIES

4a Output fuse module 093.63 for 5x20 mm fuse. Multi-state fuse module.

4b As delivered, the socket comes without a fuse module. However, the absent fuse is internally replaced with an electrical link - which allows the interface relay to be used without a fuse module. In this state, the peg/indicator is visually hidden (fig.4b).

4c With fuse module inserted, the fuse is positioned electrically in series with the common output terminal of the interface module (11 for EMR versions, 13+ for SSR versions, 15 for EMR timer, 15+ for SSR timer). This state is indicated by the peg/indicator.

4d If the fuse module is extracted (for example; because the fuse element has blown) the output circuit will be locked open, as this will generally be the "safe option". This state is indicated by the peg/indicator.

4e In order to reinstate the output circuit it is necessary to either re-insert the fuse module (complete with functional fuse), or alternatively, return the peg/indicator to position 4b by gently applying pressure in the direction of the arrow.

