

TOP

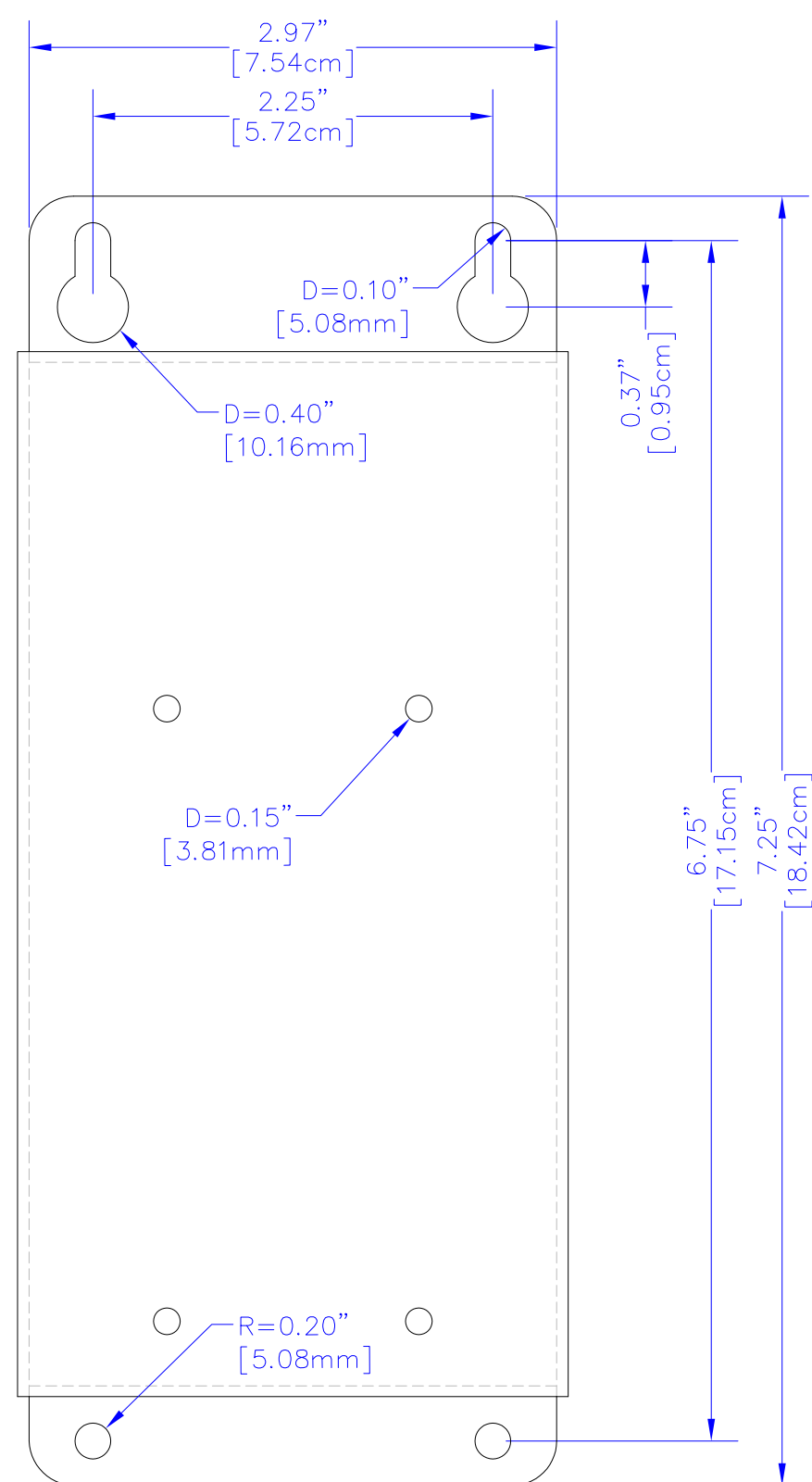

FRONT

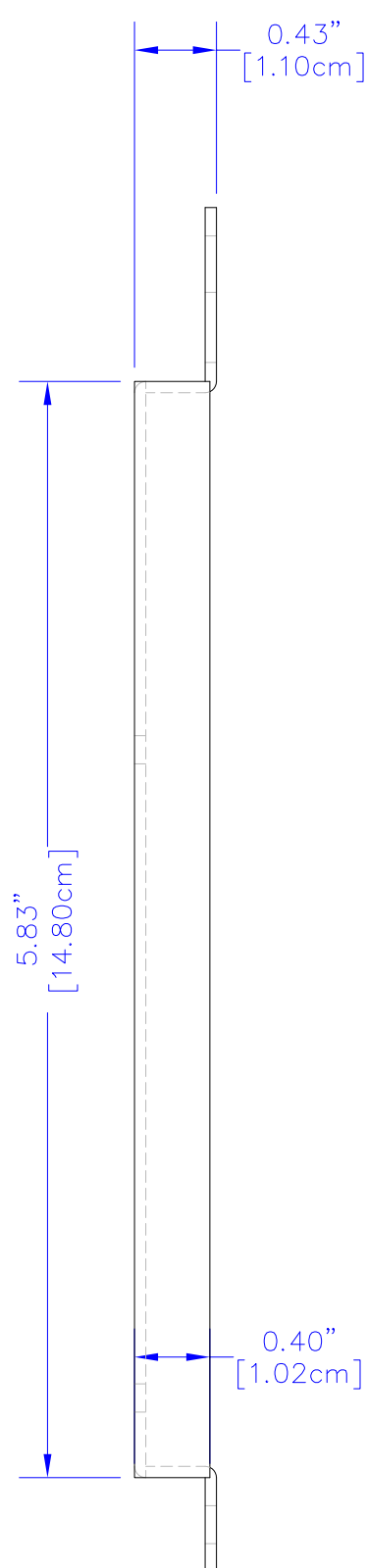

RIGHT

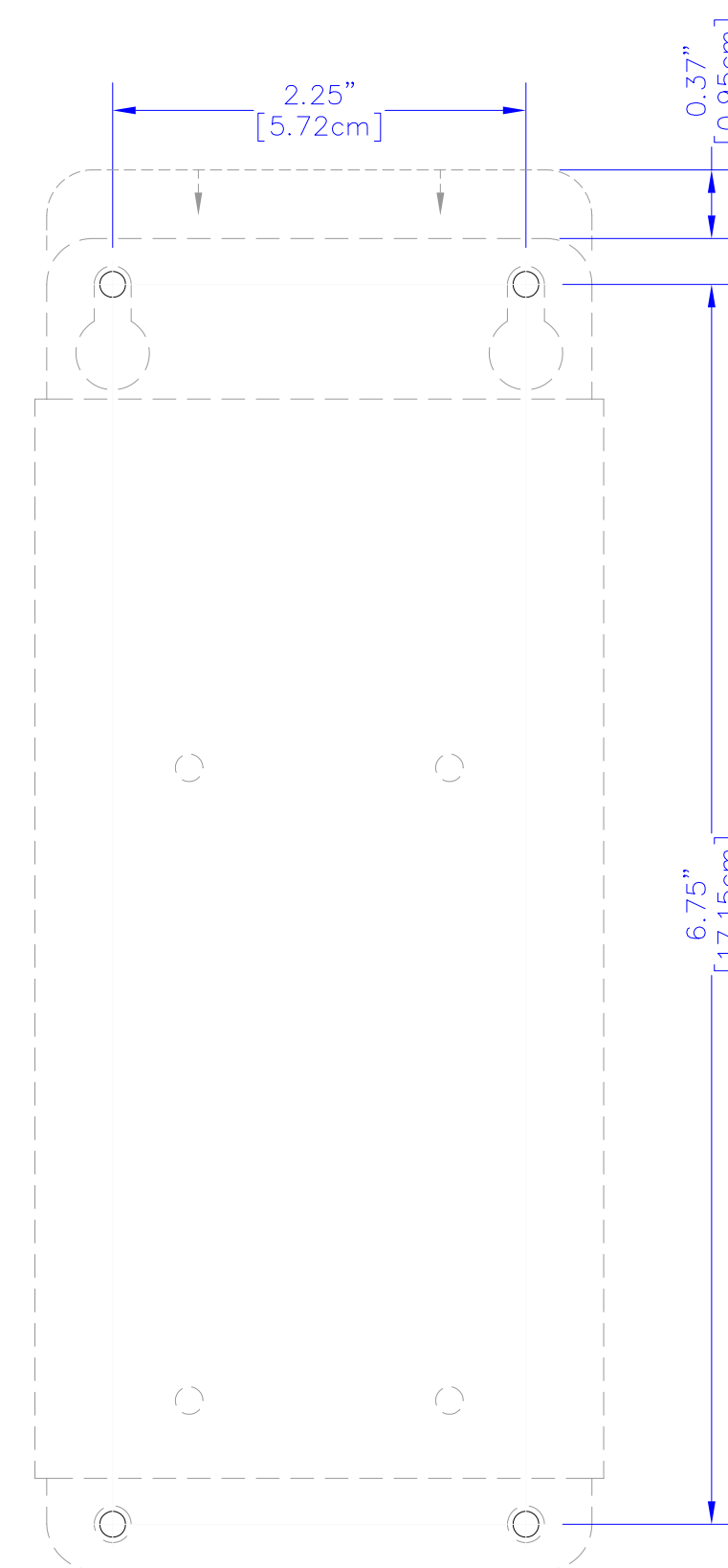

RECOMMENDED MOUNTING HOLE TEMPLATE

NT24k-NM-PMK
OPTIONAL PANEL MOUNT BRACKET



3101 International Drive, Building No. 6 - Mobile, Alabama 36606
 Phone: 251-342-2164 - www.redlion.net - Fax: 251-342-6353
 Date: 02-18-2015 Drawn By: G.R.S.
 File Name: NT24k-NM-PMK-ReferenceDrawing.dwg Scale: 1" = 1"

Note: The dimensions shown on this drawing are intended for general reference only. Please refer to the respective user manual of the specific Ethernet switch model to determine the recommended wiring and ventilation clearances.