

Technical data

Current consumption	< 50 mA
Design	Profile, QR14
Dimensions	53.5 x 49 x 14 mm
Housing material	Plastic, PBT-GF30-V0
Electrical connection	Cable with connector, M12 x 1
Cable quality	Ø 5.2 mm, Gray, LifYY, PVC, 0.3 m
Core cross-section	4 x 0.34 mm ²
Vibration resistance	55 Hz (1 mm)
Shock resistance	30 g (11 ms)
Protection class	IP68 / IP69K
MTTF	138 years acc. to SN 29500 (Ed. 99) 40 °C
Power-on indication	LED, Green
Measuring range display	multifunction LED, green
Included in delivery	positioning element P1-Li-QR14/Q17L

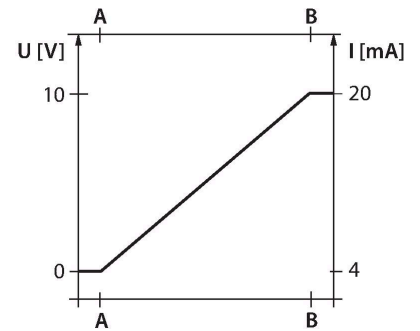

Mounting instructions

Mounting instructions/Description

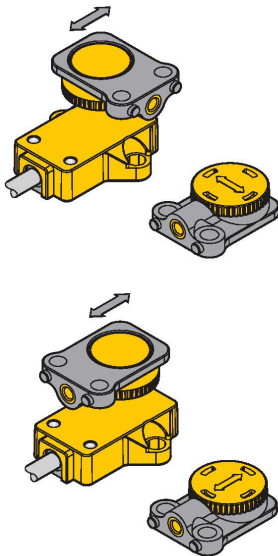

The positioning element can be mounted offset by 90°. This provides highest mounting flexibility. The measuring principle of RLC coupling makes the sensor immune to magnetized metal splinters and other interference fields.

LED indications

green

positioning element is in the measuring range

green flashing:

positioning element is in the measuring range, the distance is too large. This is indicated by a weaker signal

off

positioning element is outside the coverage.

Accessories

P1-LI-QR14/Q17L

1590724

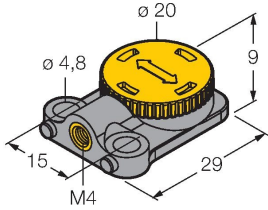

Floating positioning element for linear position sensors LI-QR14 and LI-Q17L; transverse and longitudinal mounting possible; the nominal distance to the sensor is 1.5 mm; pairing with the linear position sensor at a distance of up to 3 mm or a misalignment tolerance of up to 3 mm

Wiring accessories

Dimension drawing

Type

Ident. no.

RKS4.4T-2/TXL

6626333

Connection cable, M12 female, straight, 4-pin, shield on coupling nut; cable length: 2 m, jacket material: PUR, black; cULus approval; other cable lengths and qualities available, see www.turck.com

