

REVISIONS				
Rev	Description	Designer	Approved	Date
01	Created	KTN	KLI	2017-06-07
02	Front Panel new color, Description changed, USB-removed	KTN	KLI	2019-05-16
03	Front panel changed	KTN	KLI	2019-07-04

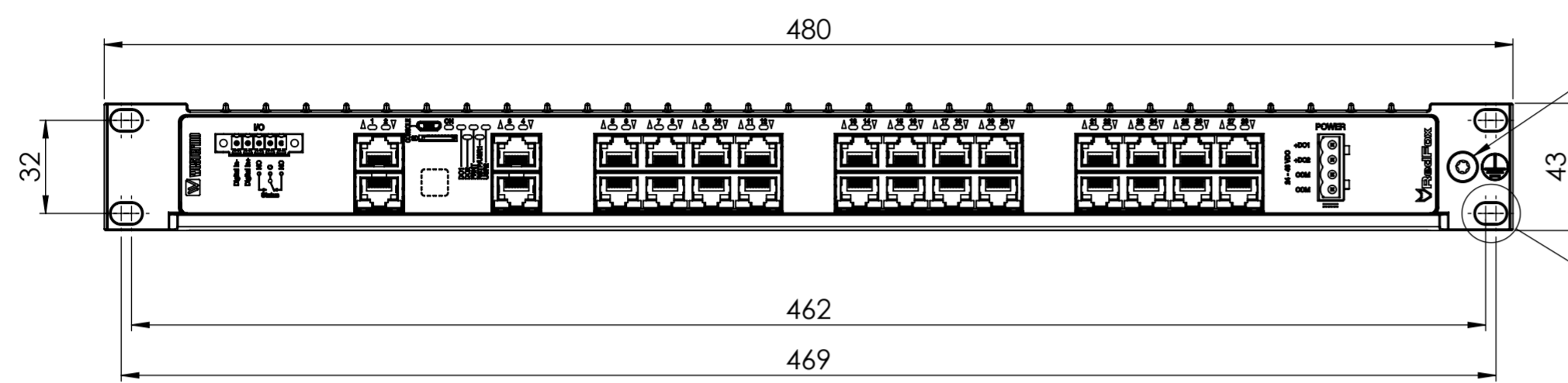

Grounding Point Screw M5 x 0.8 mm - Roll tap true all

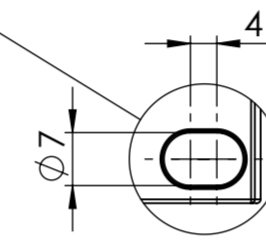
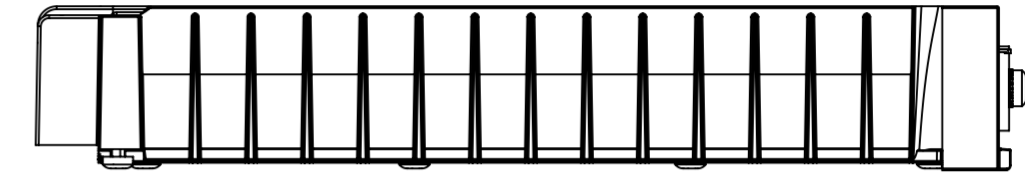

DETAIL A  
SCALE 1 : 1

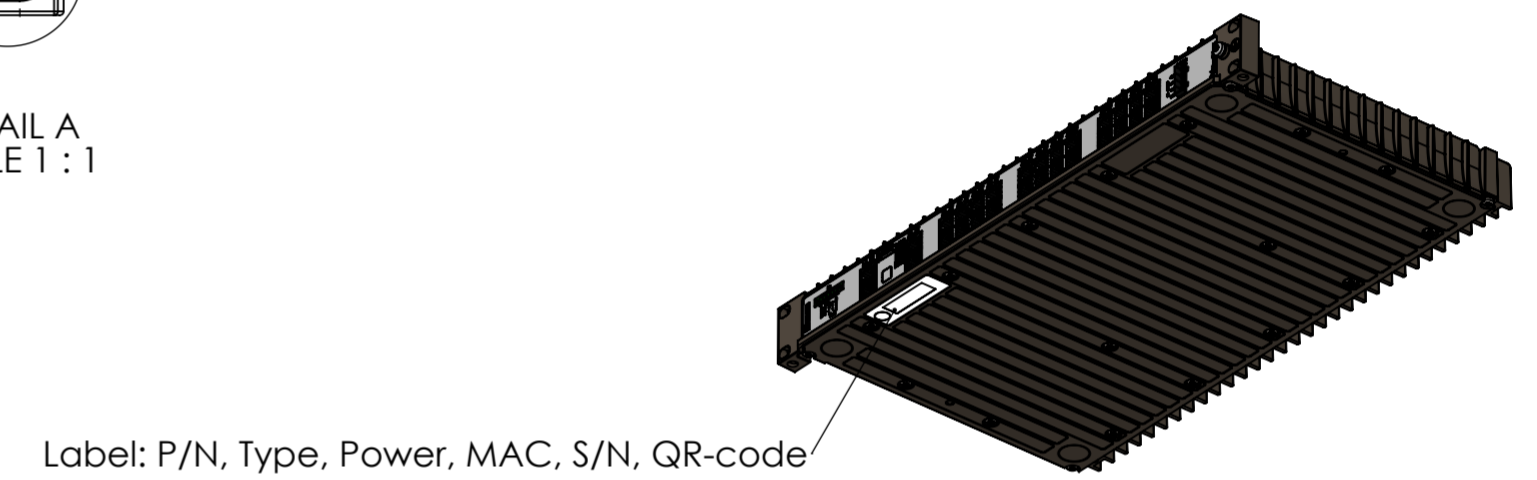
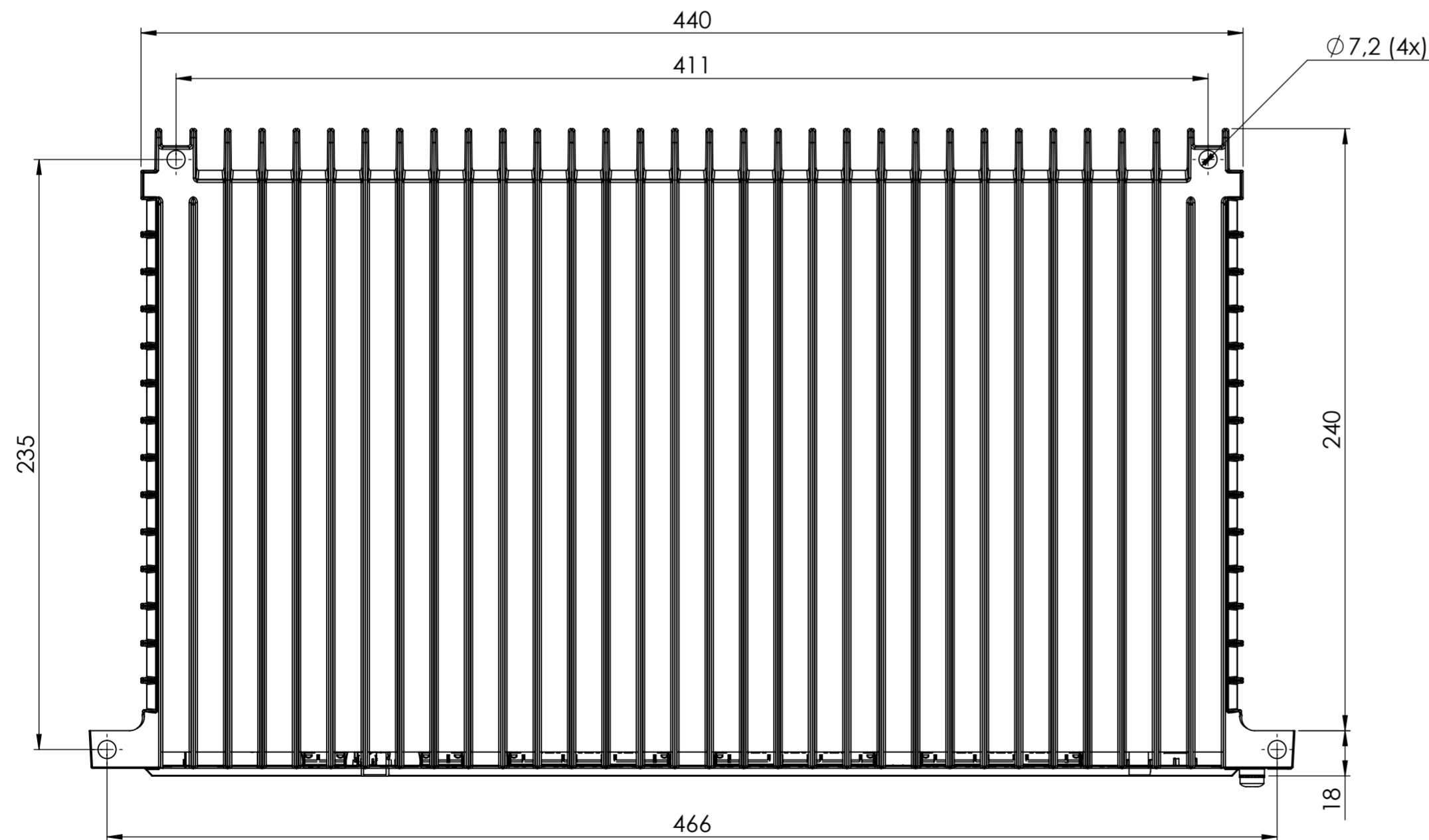

Label: P/N, Type, Power, MAC, S/N, QR-code

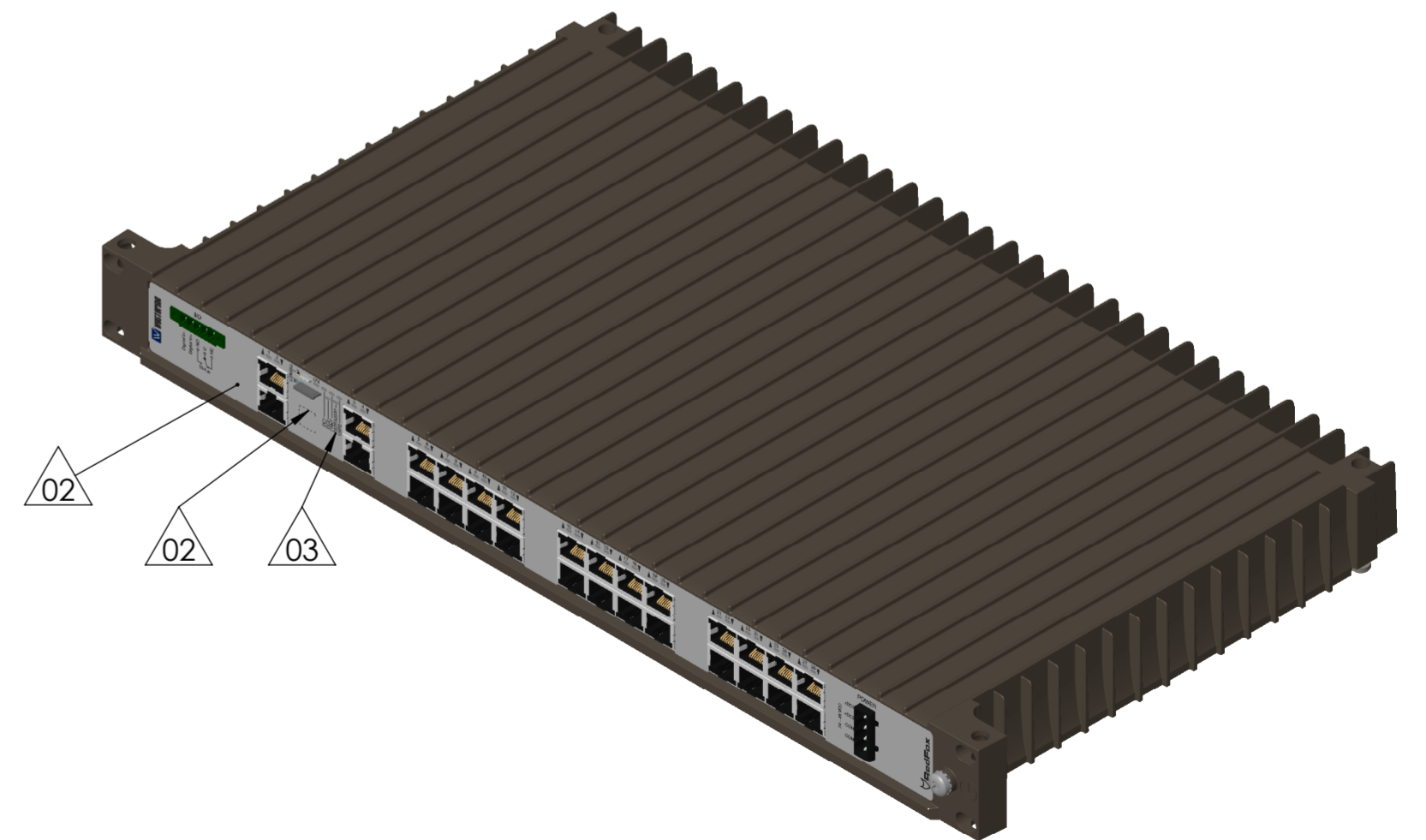

02

Material/Notes		Notes		Tolerance ±1mm	
		<b>RedFox-5528-T28G-LV</b>		Designer	KTN
				Approved	KLI
Drawing No: 3641-4500-UD-03		Date: 2017-06-07		Scale	1:2
				Sheet	1(1)
				Status	Approved